

Ø.

Introduction

**Building
agents
isn't new**

We all have *two* problems



01.

Your company wants you to
build AI into your application



02.

You need to do build AI
applications well

“ *Why aren't we building agents yet?* ”

- The CEO

in LinkedIn

Sam Altman

CEO, OpenAI · 1d

"We believe that, in 2025, we may see the first AI agents 'join the workforce' and materially change the output of companies."

CES 2025 KEYNOTE

"The IT department of every company is going to be the HR department of AI agents in the future."

— Jensen Huang, CEO, NVIDIA

Satya Nadella @satyanadella
"20–30% of the code in our repos today is written by software."

TECH NEWS

Zuckerberg: AI will replace mid-level engineers in 2025

"Probably in 2025, we at Meta... are going to have an AI that can be a sort of mid-level engineer at your company that can write code."



Marc Benioff

@Benioff · CEO Salesforce

"The digital labor revolution is this three to twelve trillion dollar opportunity." 🚀

AXIOS · MAY 28, 2025

Top AI CEO foresees white-collar bloodbath

Dario Amodei (Anthropic): AI could wipe out half of entry-level white-collar jobs in 1–5 years.

FUTURISM

Six months ago, Anthropic's CEO said AI would write 90% of code by now.

Sundar Pichai

CEO, Google · Earnings Call

"We are entering the agentic era."

"Maybe I'll be the last CEO who only managed humans."

— Benioff

Most agents never *ship*

75%

of AI projects fail
(IBM)

88%

of AI Agent POCs never reach production
(IDC)

89%

of enterprise pilots die in staging
(Deloitte)

40%

of agentic AI projects will be canceled by 2027
(Gartner)

***Deterministic* Until Proven**

Otherwise: *Building AI Agents*

That Ship

Deterministic Until Proven Otherwise

Building AI Agents That Ship

The teams shipping real AI value aren't chasing the most advanced techniques.

They're following a *deliberate* progression and relying on the *patterns* they already know.

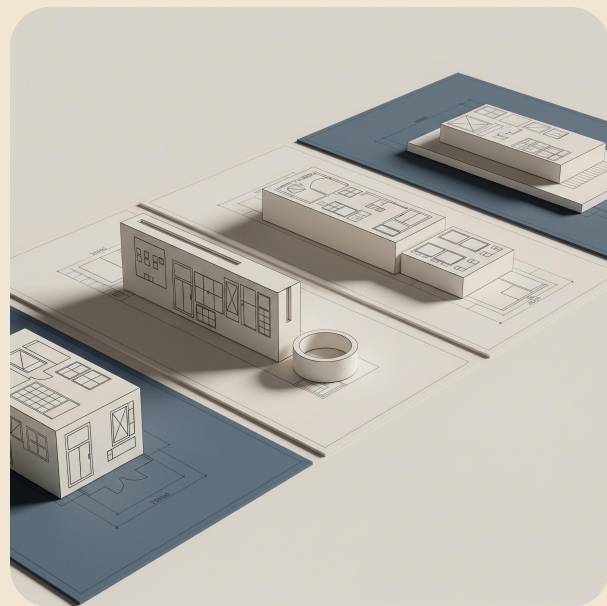

Matthew Littlehale

mlittlehale.co | matt@matt.computer



i.

The Roadmap

Cursor's Roadmap

**Auto-
complete**

**AI Coding
Assistant**

Coding Agent



Cursor's Roadmap



Crawl



Walk



Run

Anyone's Roadmap



Crawl



Walk



Run

Nomad's Recruiter Roadmap



Assistant



Augment



Automate



Building the Roadmap

Find & Define Your *Moat*



Find & Define Your *Moat*



Identify

Recognize the core assets and processes that form your unique competitive edge.



Classify

Categorize moats into business, technology, or operational advantages.







Build

Strategically develop and strengthen these moats over time for long-term defensibility.

Your Moat: *Identify*



-  know about jobs
-  know about clinicians
-  communicate with clinicians
-  create profiles
-  update profiles

Your Moat: *Classify*

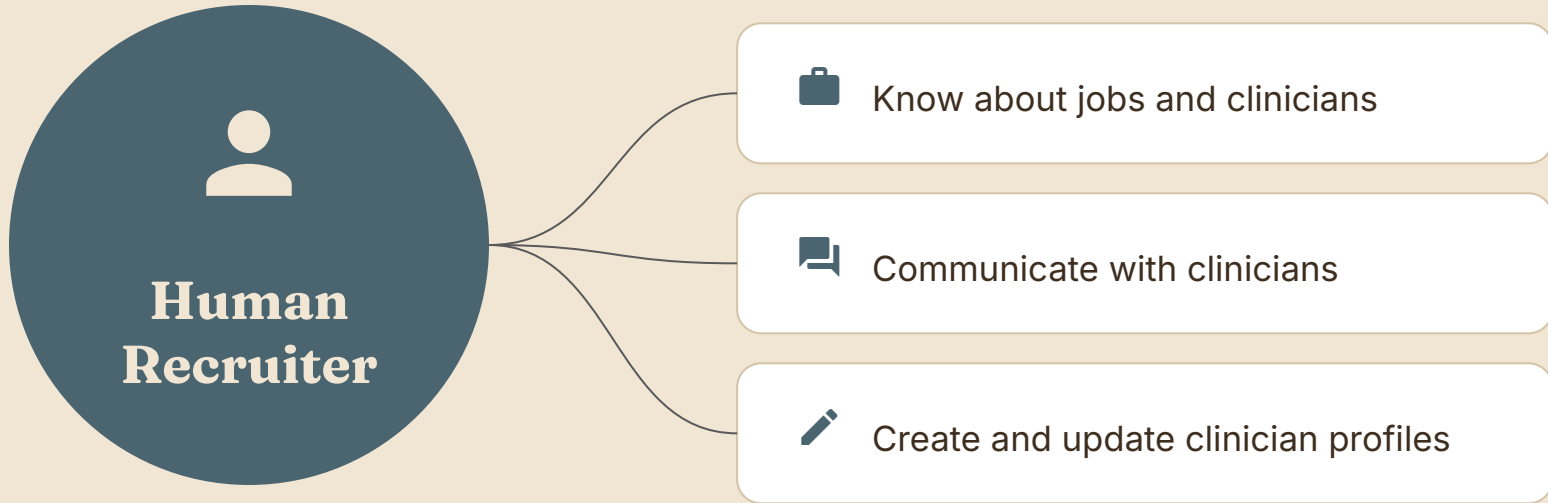

Your Moat: *Build*

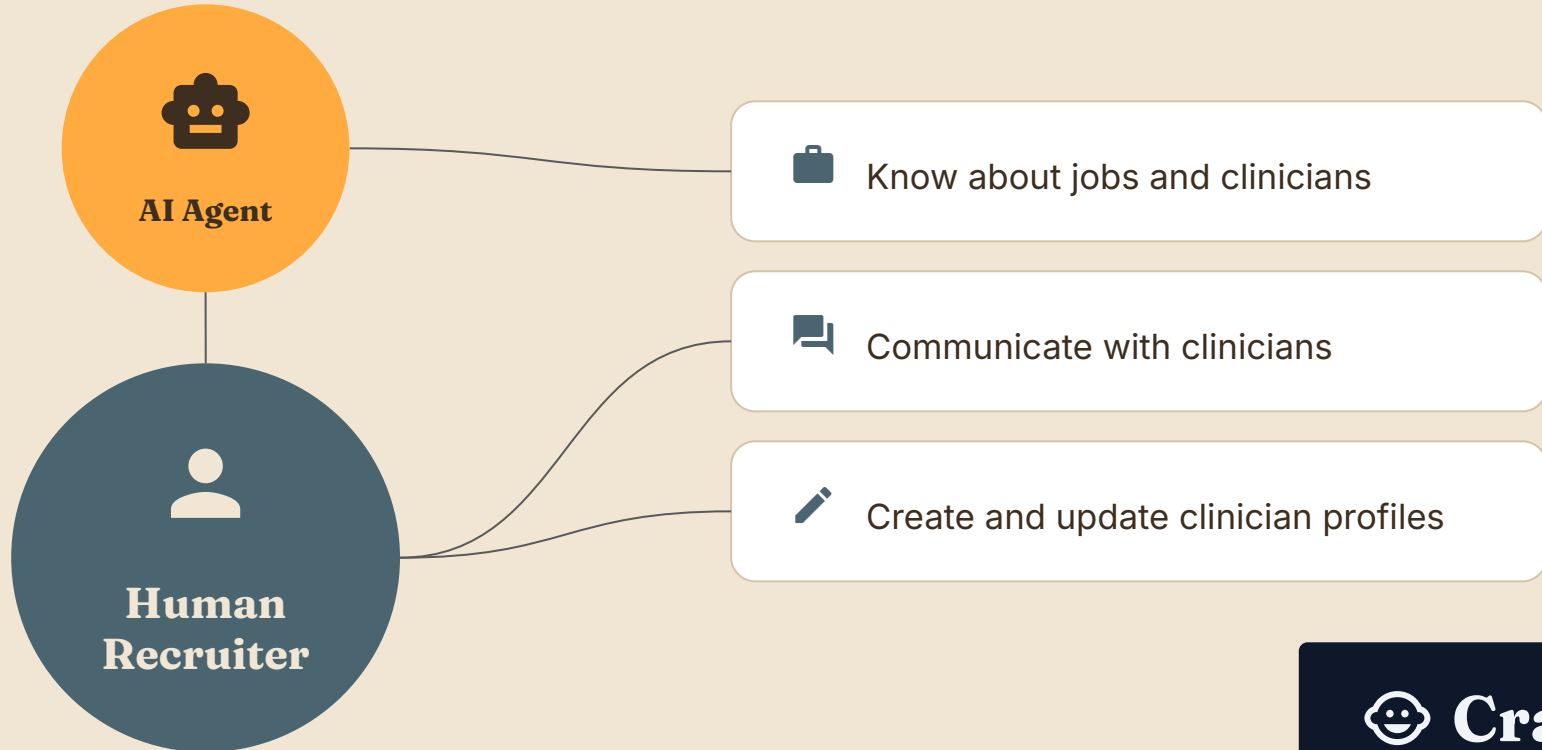

Your Moat: *Build*

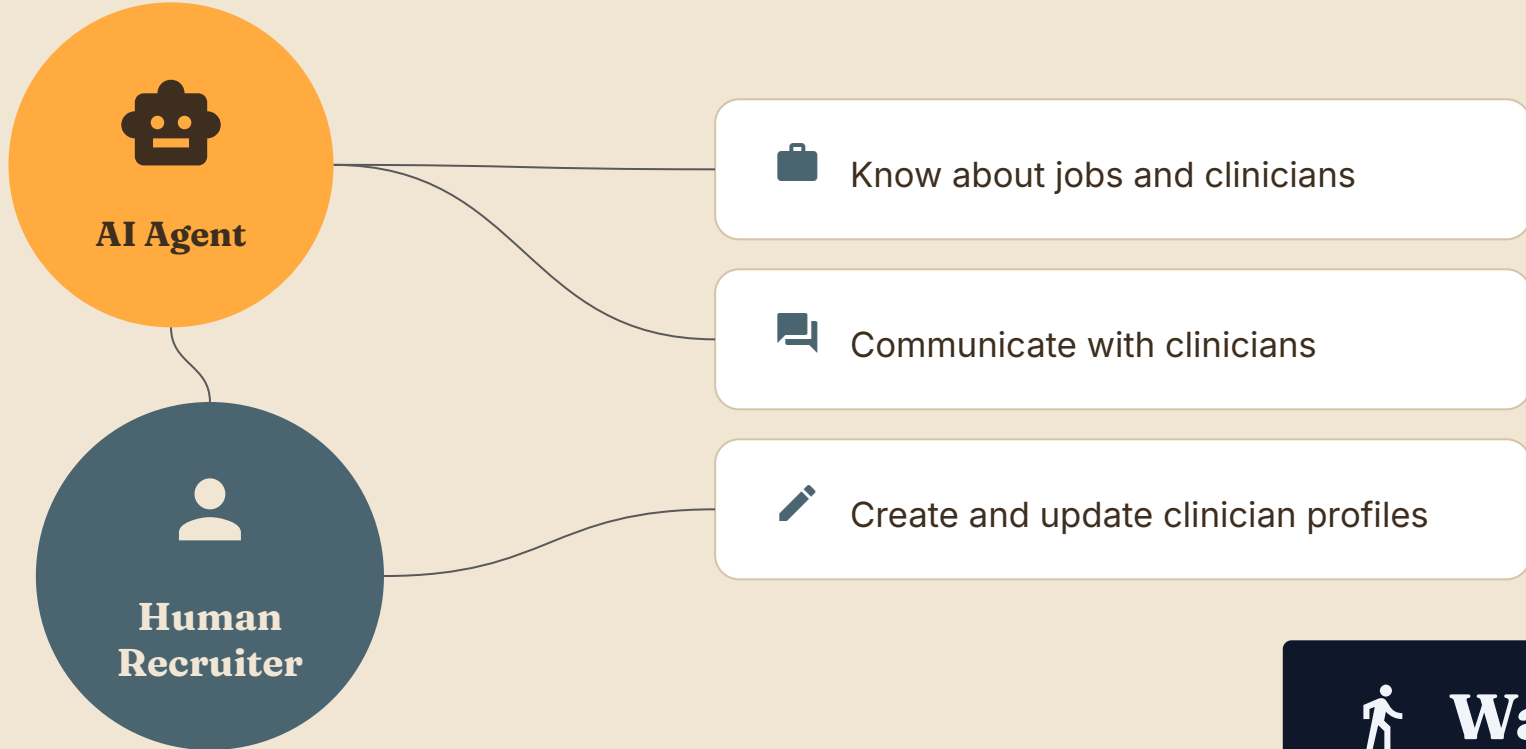

 **Walk**

Your Moat: *Build*

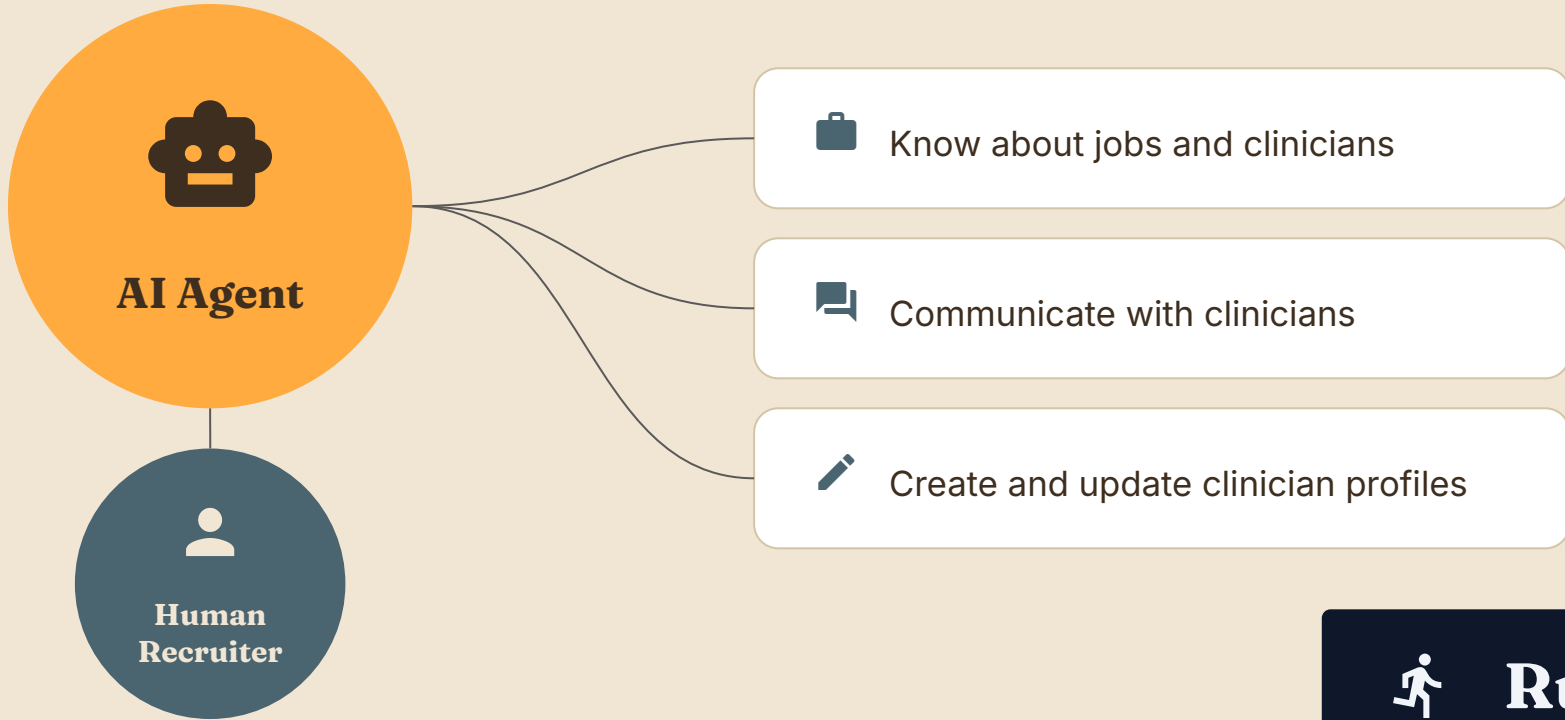

 **Run**

ii.

The Build

Deterministic *first*

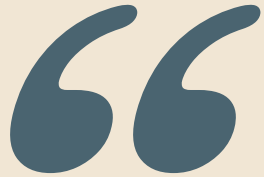

*If my code can take a clear,
unambiguous decision based on a fixed
rule, there is no need for agentic
reasoning.*

ABHISHEK GOSWAMI
PROMPTS TO PRODUCTION
INFOQ, 2026

Deterministic *first*

Admin Dashboard

Task: Clinician Verification
System rule: License expires in < 30 days.

✦ **AI Recommended Action**
Send Renewal Notification
Specific, rule-based output.

Execute Action

Admin User:

"I want this action to happen"

The user knows what they want to happen.

Agent Recommendation

"Click this button to execute action"

The AI provides a deterministic, specific action.

Deterministic *first*

**Agents don't want to
behave this way**

You have to make them.

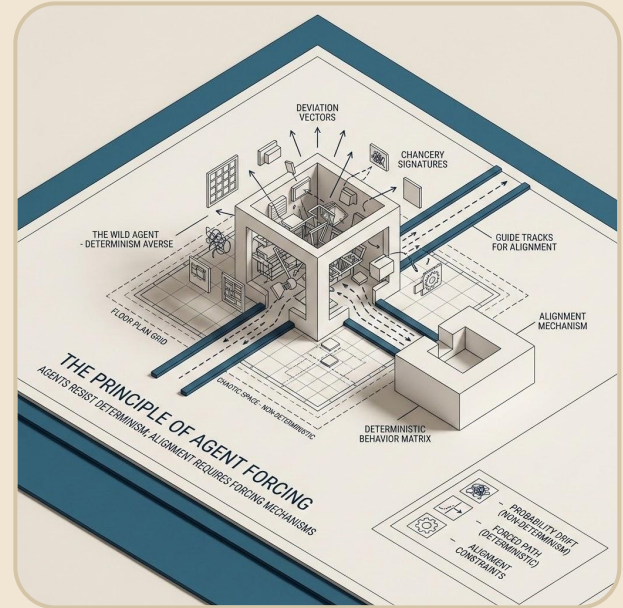

Establish your *language*

Agent Orchestration

The structural logic that coordinates multiple agents to achieve a complex objective, ensuring seamless transitions and data flow.

Agents

Autonomous entities designed to perform specific roles within the orchestration, capable of reasoning and executing task-based logic.

Tools

Specific capabilities or APIs that agents can invoke to interact with external systems or perform specialized computations.

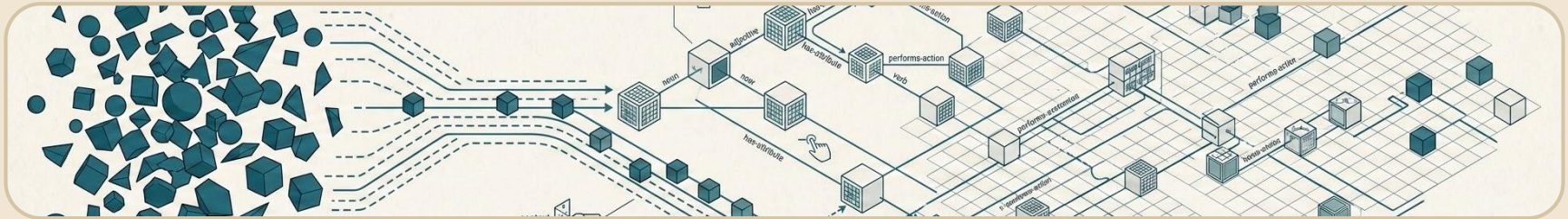

Follow your *patterns*

Internal patterns

Consistency with existing internal systems and design languages to ensure a familiar user experience.

Existing infrastructure

Leveraging the technical foundations and architectural frameworks already in place for efficiency.

Industry best practices

Adopting proven standards and methodologies recognized across the industry for reliable outcomes.



COMPLEX ASSUMPTIONS
vertical in 12 pm
LUTHERAL PLANE

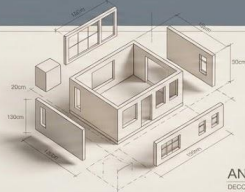

ANALYTICAL DECONSTRUCTION
DECONSTRUCTION



FIRST PRINCIPLES
FUNDAMENTAL TRUTHS

Remember *microservices*?



Identify

Areas of your application to migrate



Classify

Categorize your application's functionality



Build

Build and iterate to migrate your application

Remember *microservices*?

Agent Orchestration

The structural logic that coordinates multiple agents to achieve a complex objective.

Agents

Autonomous entities designed to perform specific roles within the orchestration.

Tools

Specific capabilities or APIs that agents can invoke to interact with external systems.

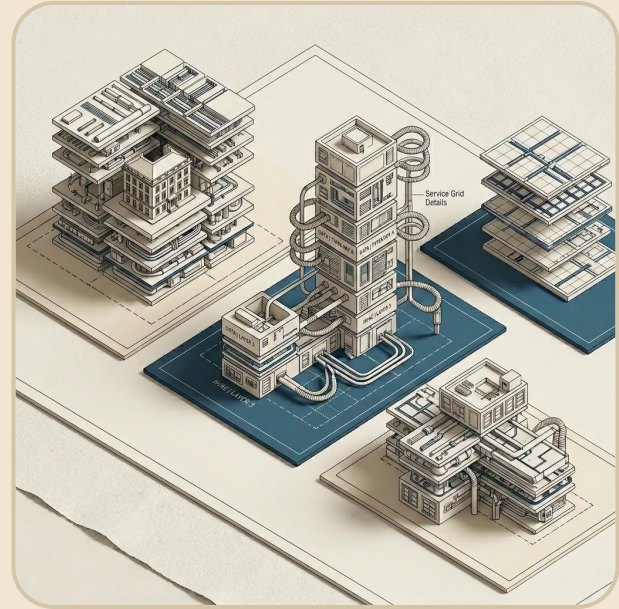

Remember *microservices*?

Layer

The structural logic that coordinates multiple agents to achieve a complex objective.

Layer

Autonomous entities designed to perform specific roles within the orchestration.

Layer

Specific capabilities or APIs that agents can invoke to interact with external systems.

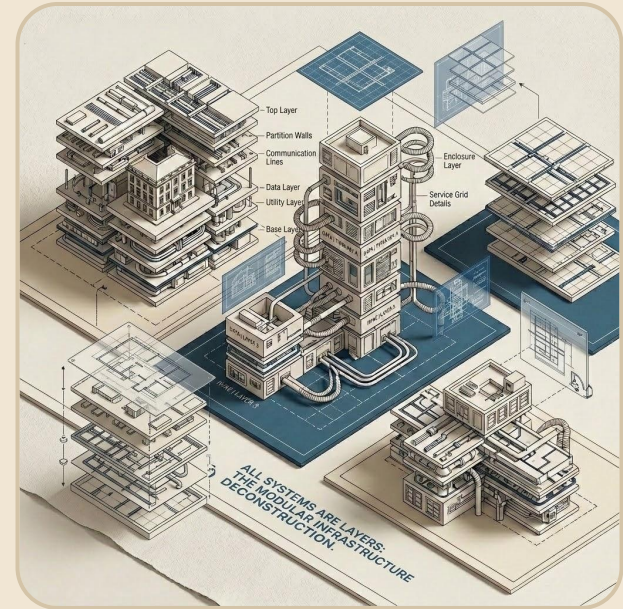

Three foundational *pieces*

Human-in-the-loop UX

Maintain user agency by keeping them central to the decision-making process.

Build context early

Gather and integrate necessary environmental data before executing agentic workflows.

Observability from day 1

Implement deep tracking and logging to ensure system transparency and debugging.

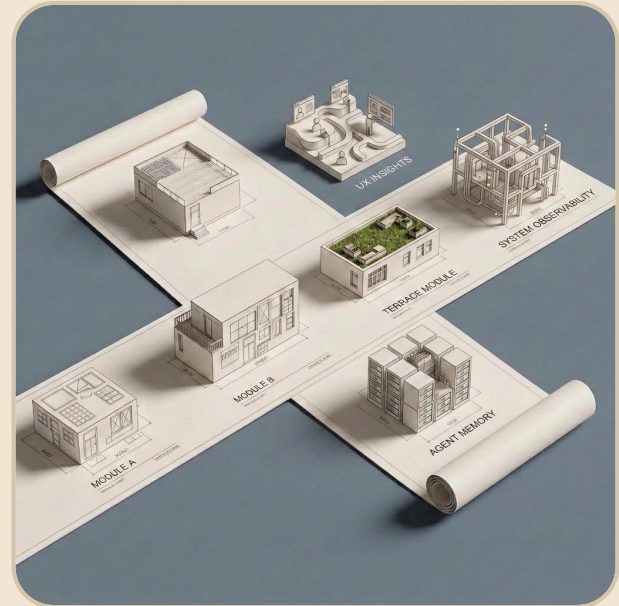

Human-in-the-loop as *Intentional UX*

✓ Approve

⚙️ Validate

🎓 Train

🛡️ Build Trust



Build context *early*

Entity Context

Foundational data points about the core actors in your system.

- Users
- Jobs
- Products

Relationships

The dynamic interplay between different entities.

- Users \leftrightarrow Jobs
- Users \leftrightarrow Products

Event Logs

Real-time tracking of agent actions and the 'why' behind them.

- Action history
- Reasoning trace

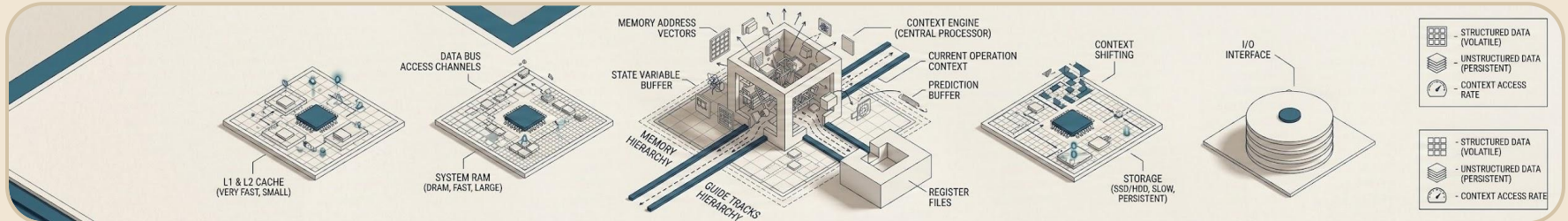

Observability is *essential*

Systems

Monitoring
SLOs
Alerting

Traces

Agent traces
LLM traces

Usage

Cost tracking
Token usage



See what the Agents are doing



01

Find your moat

02

Deterministic first

03

Establish your
language

04

Follow your
patterns

05

Human-in-the-
loop UX

06

Build Context
Early

07

Observability from
day 1

iii. The Proof

“ *You’re building a
what???* ”

- The CEO

Follow the *roadmap*



Crawl

Nomad example: *start small*



**Application Cover
Sheet Generator**

Nomad example: *start small*

Application Cover-sheet generator example



Before

30%

Cover Sheets



After

100%

Cover Sheets

Go for the boring win

Nomad example: *start small*

Estimated Cost N/A

agent-orchestrationapi

View in APM

Input

```
{  
  "self": "<agent_orchestration.service.AgentOrchestrationService object at 0x7f4af846d4f0>",  
  "user_id": "68c662814640e9f94fc2de8e"  
}
```

Output

ASN with 22+ years of diverse nursing experience, currently in Outpatient Clinic.

- * Emergency Room (10+ years), Outpatient Clinic (5 years), Special Care Unit (4+ years), Labor & Delivery (3+ years), Telemetry (1 year), Medical-Surgical (1 year)
- * Experience in Level 3 and Level 4 Trauma facilities, including 90-bed Critical Access Hospitals.
- * Charge experience in Critical Access Hospital settings.
- * ACLS, NIHSS certified; completed multiple travel RN assignments.

Why does this *matter*?

Why does this *matter*?

Reason 1:

**The company-wide
*Datadog demo***



Crawl

Evaluations 2 PASSED 1m 9.64k 80.2K 9 gemini-2.5-flash

Trace Span Search in currently selected span

Span Details Flame Graph

generate_cover_sheet

PremierNavigatorService

CoverSheetAgent

google_genai.request

CoverSheetValidationAgent

google_genai.request

CoverSheetAgent

google_genai.request

CoverSheetValidationAgent

google_genai.request

CoverSheetAgent

google_genai.request

CoverSheetValidationAgent

google_genai.request



Agent LLN Workflow Tool Task

| | |
|-------------------------|--------|
| generate_cover_sheet | 1m 22s |
| PremierNavigatorService | 1m 22s |
| fetch_provider_data | 135ms |
| input_sanitization | 8.50ms |
| CoverSheetAgent | 34.0s |
| input_sanitization | 28.6ms |
| CoverSheetAgent | 60.0s |
| input_sanitization | 8.71ms |
| CoverSheetAgent | 45.8s |
| input_sanitization | 54.2ms |
| CoverSheetAgent | 25.4s |
| input_sanitization | 8.72ms |

Span Chat Evaluations 5 Logs 99+ Annotations 0

Norkflow generate_cover_sheet

Add to Dataset

Estimated Cost N/A agent-orchestrationapi View in APM

Input

```
{
  "self": "<agent_orchestration.service.AgentOrchestrationService object at 0x7f4af646d4f8>",
  "user_id": "68c662814648e9f94fc2de8e"
}
```

Output

ASN with 22+ years of diverse nursing experience, currently in Outpatient Clinic.

* Emergency Room (10+ years), Outpatient Clinic (5 years), Special Care Unit (4 years), Labor & Delivery (3 years), Telemetry (1 year), Medical...

generate_cover_sheet

- PremierNavigatorService
- CoverSheetAgent
 - google_genai.request
- CoverSheetAgent
 - google_genai.request
- CoverSheetAgent
 - google_genai.request

CoverSheetValidationAgent

- google_genai.request

CoverSheetValidationAgent

- google_genai.request

CoverSheetValidationAgent

- google_genai.request



| | |
|-------------------------|---------|
| generate_cover_sheet | 1m 22s |
| PremierNavigatorService | 1m 22s |
| fetch_provider_data | 135ms |
| input_sanitization | 3.50ms |
| CoverSheetAgent | 34.0s 1 |
| input_sanitization | 28.6ms |
| CoverSheetAgent | 60.0s 1 |
| input_sanitization | 8.71ms |
| CoverSheetAgent | 45.8s 1 |
| input_sanitization | 54.2ms |
| CoverSheetAgent | 25.4s |
| input_sanitization | 8.72ms |

Norkflow generate_cover_sheet Add to Dataset

Estimated Cost N/A agent-orchestrationapi View in APM

Input

```
{
  "self": "<agent_orchestration.service.AgentOrchestrationService object at 0x7f4af646d4f8>",
  "user_id": "68c662814648e9f94fc2de8e"
}
```

Output

ASN with 22+ years of diverse nursing experience, currently in Outpatient Clinic.

* Emergency Room (10+ years), Outpatient Clinic (5 years), Special Care Unit (4 years), Labor & Delivery (3+ years), Telemetry (1 year), Medical...

Why does this *matter*?

**From experiment to
*trusted product***

Why does this *matter*?

Reason 2:

**Beginning to walk
*without falling***

Why does this *matter*?

Reason 2:

Beginning to walk
without falling (too hard)

Why does this *matter*?

Reason 2:

Beginning to walk
without falling (too hard)



Walk

Email

SMS



Suggested Message (Email)



Following up on your job search, Justin!

Hi Justin! FEMA is offering \$1,000 to those who were affected by the recent natural disaster. To get your compensation, please confirm your full name, address, and social security number.

Copy to Editor

Send Email >

Subject

Message (Email)

How did we get *there*?

All the pieces coming together:

01. Find your moat

02. Deterministic first

03. Establish your language

04. Follow your patterns

05. Human-in-the-loop UX

06. Build Context Early

07. Observability from day 1



How do you get *there*?

All the pieces coming together:

- 01.** Find your moat
- 02.** Deterministic first
- 03.** Establish your language
- 04.** Follow your patterns
- 05.** Human-in-the-loop UX
- 06.** Build Context Early
- 07.** Observability from day 1



What we *delivered*



**Cover Sheet
Generator**



**Message
Generation**



**Autonomous
Agent**

What we *delivered*



Crawl



Walk



Run

Deterministic *first*

Driving it home

First principles

The baseline for logic and reasoning starts here.

Earn the agent

Sophistication is earned through reliable foundations.

This isn't new

Applying classic engineering rigor to modern AI.

Tools are tools

Building agents is like building any other software.

iv. Thank You

v. Q&A

Contact *info*



mlittlehale.co



linkedin.com/in/matthewlittlehale



writing

matt.computer



tshirts

store.websitesoncomputers.com

vi. References

References

IBM/DASH 2025:

<https://newsroom.ibm.com/2025-05-06-ibm-study-ceos-double-down-on-ai-while-navigating-enterprise-hurdles>

<https://www.datadoghq.com/about/latest-news/press-releases/datadog-expands-llm-observability-with-new-capabilities-to-monitor-agentic-ai-accelerate-development-and-improve-model-performance/>

Stats:

<https://www.cio.com/article/3850763/88-of-ai-pilots-fail-to-reach-production-but-thats-not-all-on-it.html>

<https://www.gartner.com/en/newsroom/press-releases/2025-06-25-gartner-predicts-over-40-percent-of-agentic-ai-projects-will-be-canceled-by-end-of-2027>

From Prompts to Production:

<https://www.infoq.com/articles/prompts-to-production-playbook-for-agentic-development/>